

ACACIA AVENUE

MARSHALL BOULEVARD
Scale 1" = 20'

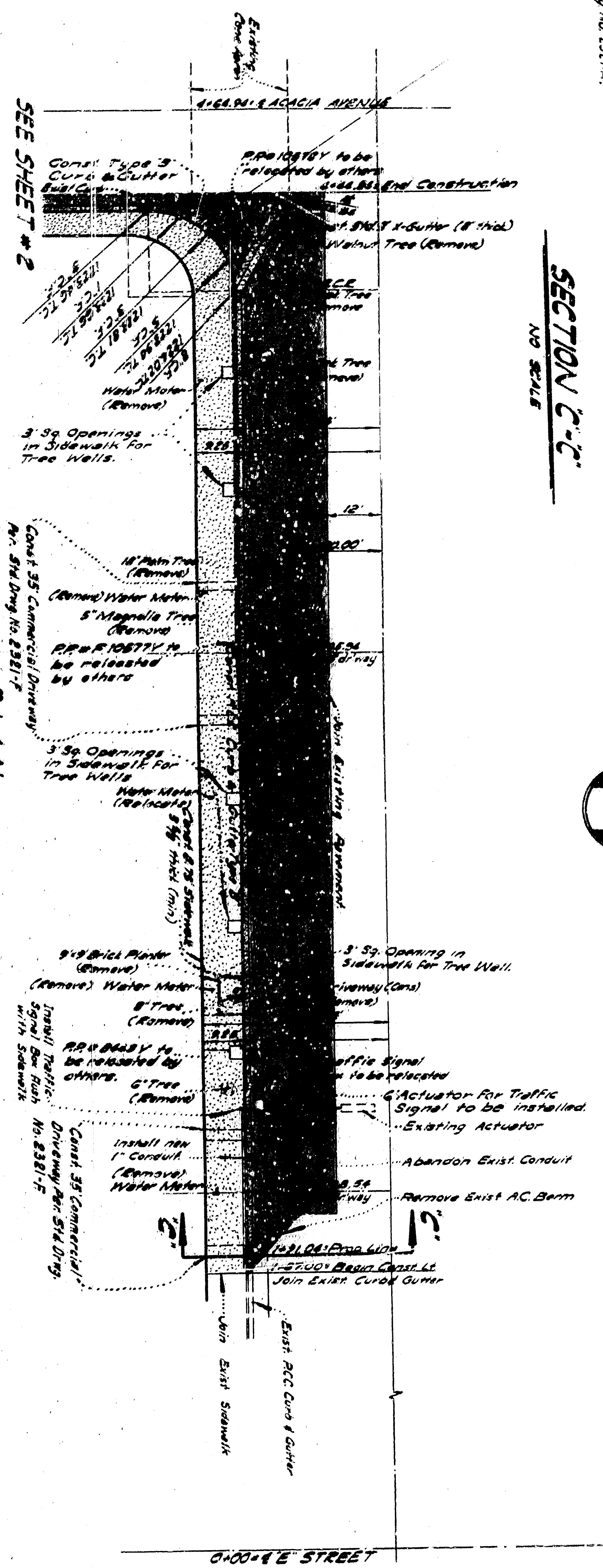

SECTION 2-2'
NO SCALE

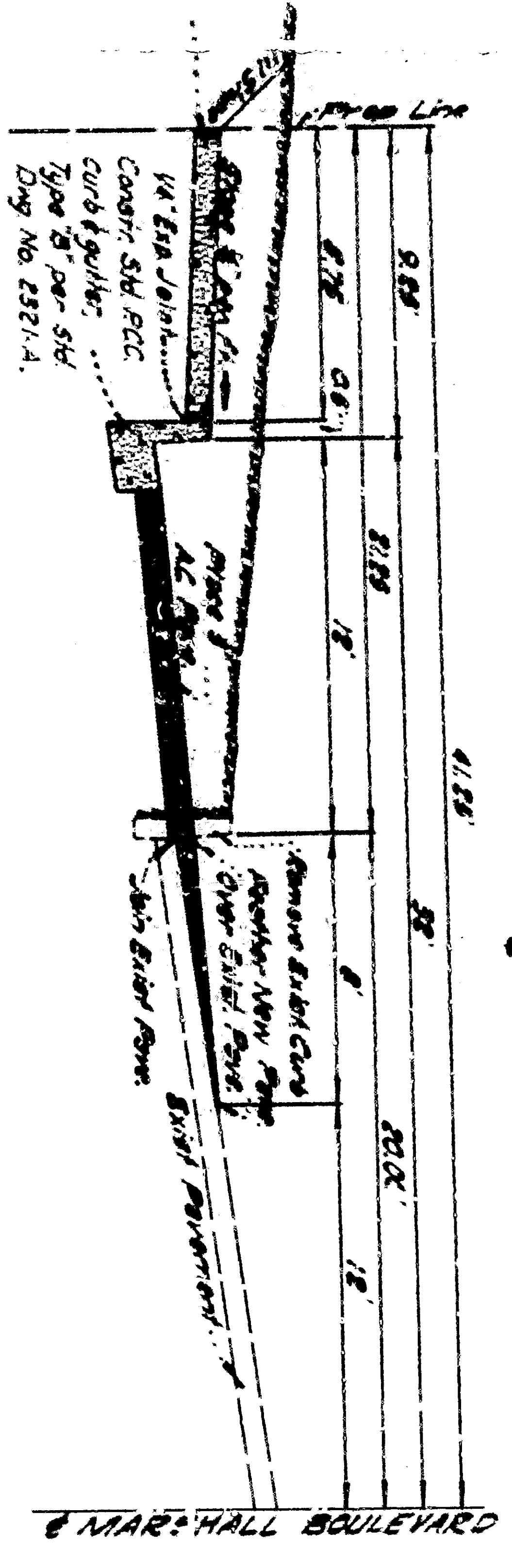
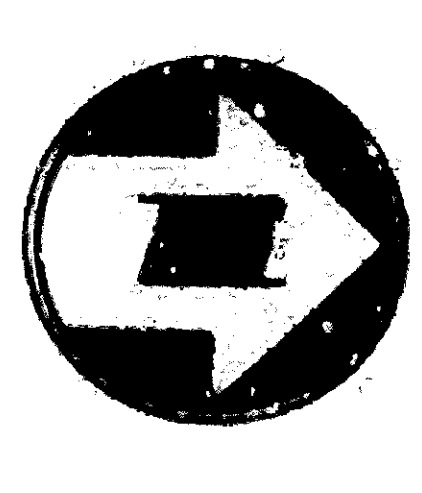

MARSHALL BOULEVARD
Scale: 1" = 20' Vert. 1" = 2'



NOTES:
1. All work indicated on these plans shall be done in conformity with applicable provisions of Standard Specifications for Road and Streetwork, Drawings No. 2301 on file in the office of the City Engineer.
2. BENCH MARK: Range Survey, in middle of curb facing N.W. corner of 1225 E STREET - ELEVATION 1227.0 N.A.S.L.
3. The utility companies shall be notified 30 days prior to construction.
4. All material will have a recognized and tested laboratory. If the results of these tests determine the adequacy of the indicated street sections, if the results of these tests show the existing subgrade to be inferior, sufficient base material shall be placed to support the indicated surfacing and/or the sub-grade thickness shall be increased.

James W. Willett
Registered Civil Engineer No. 8534

NOTE:
No changes shall be made in this plan without prior approval of the City Engineer. Any changes or additions must be made and approved by the City Engineer on the original tracing on file in the office of the City Engineer.

DEPARTMENT OF ENGINEERING
CITY OF SAN BERNARDINO
IMPROVEMENT PLAN & PROFILE
MARSHALL BOULEVARD, ACACIA AVENUE AND E STREET

APPROVED	1-2-10	9-6-6	DRAWN BY	PH	3/67
CITY ENGINEER			CHECKED BY	PH	SHEET 1
REGISTERED CIVIL ENGINEER NO.					OF 2 SHEETS